

平面図 1:5000

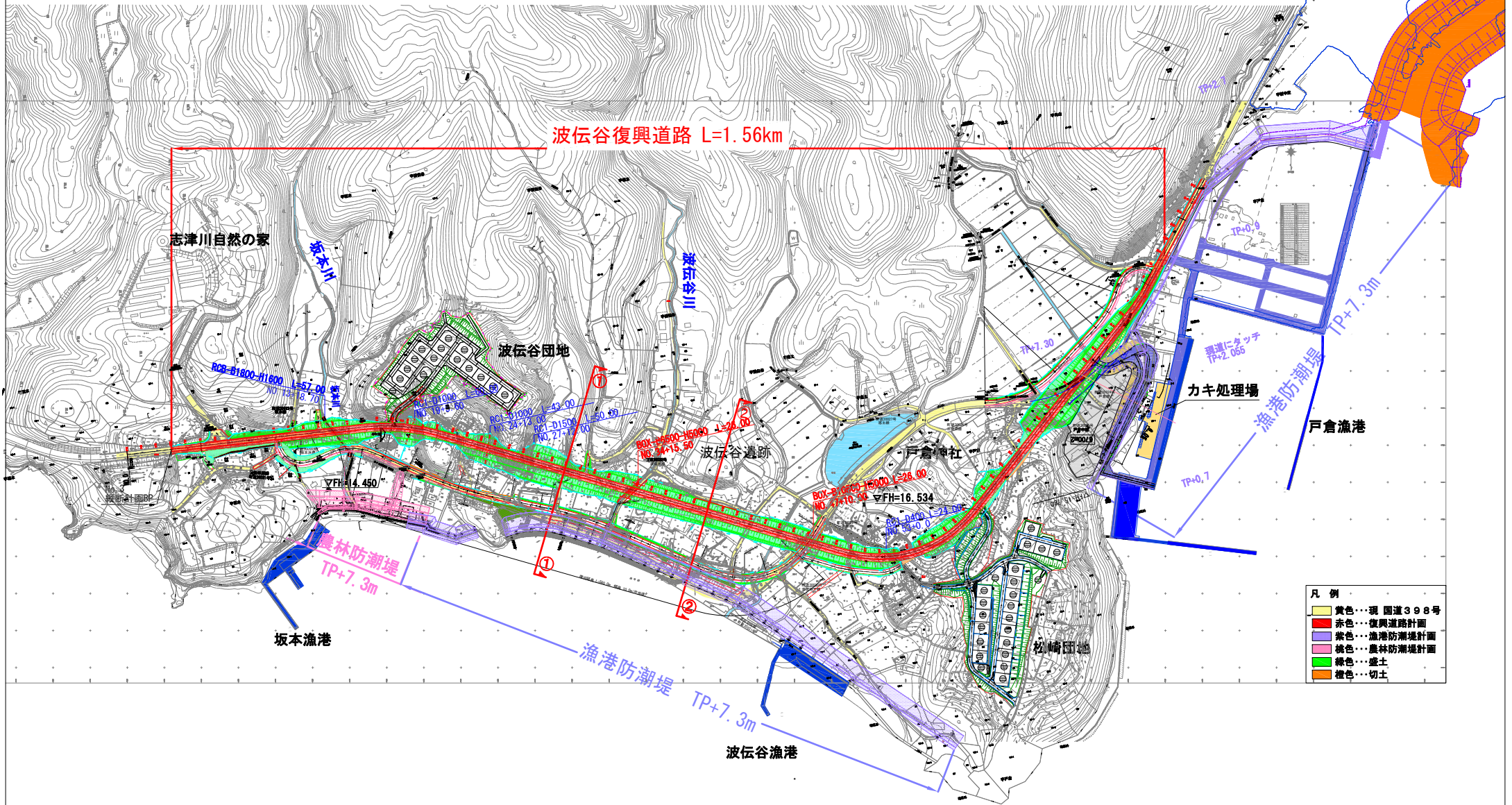

検討縦断面図

V=1:200
H=1:6000

防集路肩取付高▽14.450
取付縦断面勾配 i=8.37%

防集路肩取付高▽16.534
取付縦断面勾配 i=4.04%

波佐谷川、町道30032号
No. 34+15.5

国道398号(現道)
No. 47+10.0

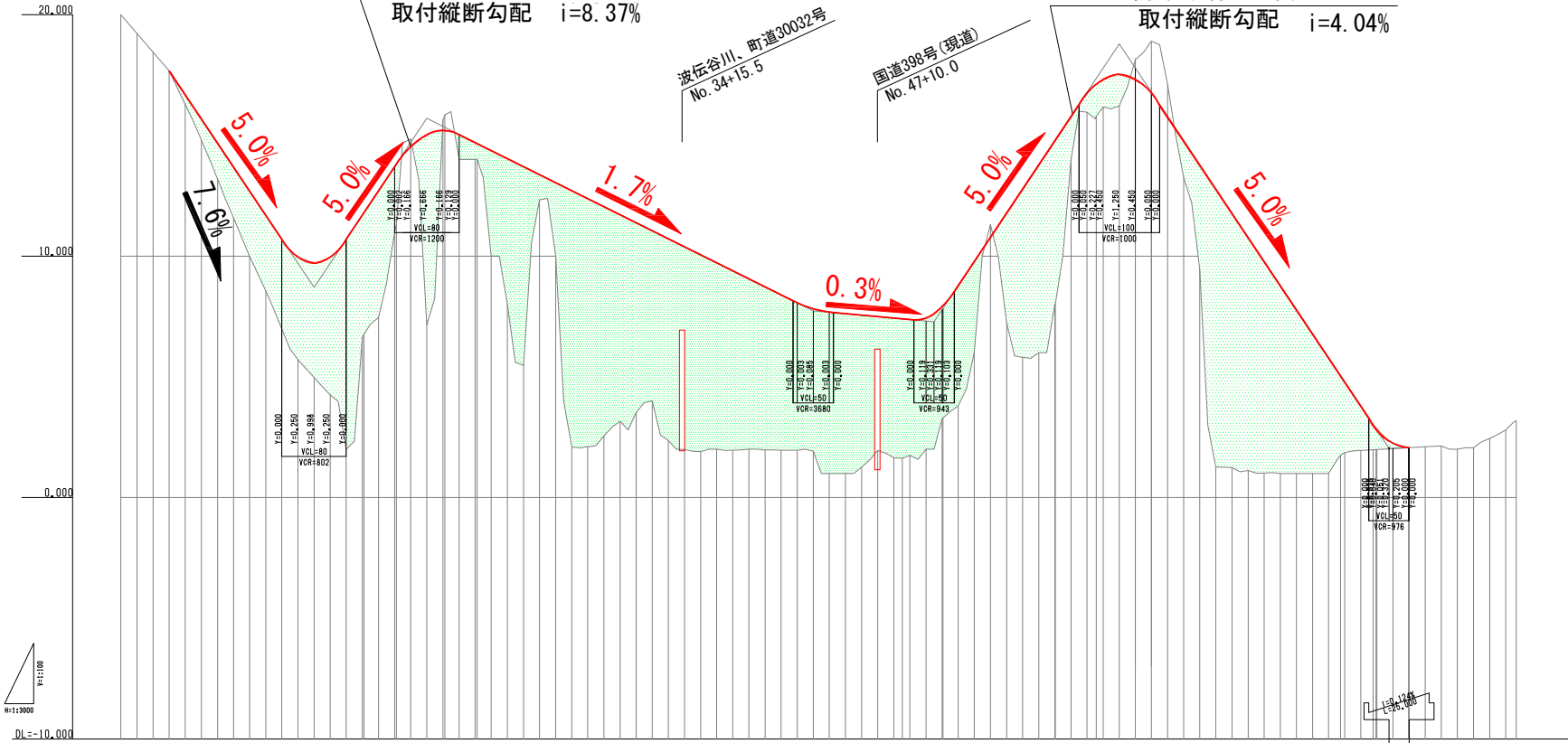

区間	幅員	延長	地盤	計画	切土	埋土	勾配
BP	0.00	0.00	20.00	0.401	0.401	17.666	
NO.1	20.00	19.105	18.206	17.666	0.891	17.666	
NO.2	40.00	17.666	16.269	15.674	1.994	17.666	
NO.3	60.00	14.607	13.168	13.681	2.700	17.666	
NO.4	80.00	11.577	9.985	12.685	3.142	17.666	
NO.5	100.00	8.995	6.990	10.692	3.712	17.666	
NO.6	120.00	6.990	4.969	9.698	4.244	17.666	
NO.7	140.00	4.969	2.940	8.700	4.701	17.666	
NO.8	160.00	2.940	0.900	7.700	5.100	17.666	
NO.9	180.00	0.900	-1.100	6.700	5.450	17.666	
NO.10	200.00	-1.100	-3.100	5.700	5.750	17.666	
NO.11	220.00	-3.100	-5.100	4.700	6.000	17.666	
NO.12	240.00	-5.100	-7.100	3.700	6.200	17.666	
NO.13	260.00	-7.100	-9.100	2.700	6.350	17.666	
NO.14	280.00	-9.100	-11.100	1.700	6.450	17.666	
NO.15	300.00	-11.100	-13.100	0.700	6.500	17.666	
NO.16	320.00	-13.100	-15.100	-0.300	6.500	17.666	
NO.17	340.00	-15.100	-17.100	-1.300	6.450	17.666	
NO.18	360.00	-17.100	-19.100	-2.300	6.350	17.666	
NO.19	380.00	-19.100	-21.100	-3.300	6.200	17.666	
NO.20	400.00	-21.100	-23.100	-4.300	6.000	17.666	
NO.21	420.00	-23.100	-25.100	-5.300	5.750	17.666	
NO.22	440.00	-25.100	-27.100	-6.300	5.450	17.666	
NO.23	460.00	-27.100	-29.100	-7.300	5.100	17.666	
NO.24	480.00	-29.100	-31.100	-8.300	4.700	17.666	
NO.25	500.00	-31.100	-33.100	-9.300	4.244	17.666	
NO.26	520.00	-33.100	-35.100	-10.300	3.712	17.666	
NO.27	540.00	-35.100	-37.100	-11.300	3.142	17.666	
NO.28	560.00	-37.100	-39.100	-12.300	2.550	17.666	
NO.29	580.00	-39.100	-41.100	-13.300	1.940	17.666	
NO.30	600.00	-41.100	-43.100	-14.300	1.310	17.666	
NO.31	620.00	-43.100	-45.100	-15.300	0.660	17.666	
NO.32	640.00	-45.100	-47.100	-16.300	0.000	17.666	
NO.33	660.00	-47.100	-49.100	-17.300	-0.660	17.666	
NO.34	680.00	-49.100	-51.100	-18.300	-1.310	17.666	
NO.35	700.00	-51.100	-53.100	-19.300	-1.940	17.666	
NO.36	720.00	-53.100	-55.100	-20.300	-2.550	17.666	
NO.37	740.00	-55.100	-57.100	-21.300	-3.142	17.666	
NO.38	760.00	-57.100	-59.100	-22.300	-3.712	17.666	
NO.39	780.00	-59.100	-61.100	-23.300	-4.244	17.666	
NO.40	800.00	-61.100	-63.100	-24.300	-4.700	17.666	
NO.41	820.00	-63.100	-65.100	-25.300	-5.100	17.666	
NO.42	840.00	-65.100	-67.100	-26.300	-5.450	17.666	
NO.43	860.00	-67.100	-69.100	-27.300	-5.750	17.666	
NO.44	880.00	-69.100	-71.100	-28.300	-6.000	17.666	
NO.45	900.00	-71.100	-73.100	-29.300	-6.200	17.666	
NO.46	920.00	-73.100	-75.100	-30.300	-6.350	17.666	
NO.47	940.00	-75.100	-77.100	-31.300	-6.450	17.666	
NO.48	960.00	-77.100	-79.100	-32.300	-6.500	17.666	
NO.49	980.00	-79.100	-81.100	-33.300	-6.500	17.666	
NO.50	1000.00	-81.100	-83.100	-34.300	-6.450	17.666	
NO.51	1020.00	-83.100	-85.100	-35.300	-6.350	17.666	
NO.52	1040.00	-85.100	-87.100	-36.300	-6.200	17.666	
NO.53	1060.00	-87.100	-89.100	-37.300	-6.000	17.666	
NO.54	1080.00	-89.100	-91.100	-38.300	-5.750	17.666	
NO.55	1100.00	-91.100	-93.100	-39.300	-5.450	17.666	
NO.56	1120.00	-93.100	-95.100	-40.300	-5.100	17.666	
NO.57	1140.00	-95.100	-97.100	-41.300	-4.700	17.666	
NO.58	1160.00	-97.100	-99.100	-42.300	-4.244	17.666	
NO.59	1180.00	-99.100	-101.100	-43.300	-3.712	17.666	
NO.60	1200.00	-101.100	-103.100	-44.300	-3.142	17.666	
NO.61	1220.00	-103.100	-105.100	-45.300	-2.550	17.666	
NO.62	1240.00	-105.100	-107.100	-46.300	-1.940	17.666	
NO.63	1260.00	-107.100	-109.100	-47.300	-1.310	17.666	
NO.64	1280.00	-109.100	-111.100	-48.300	-0.660	17.666	
NO.65	1300.00	-111.100	-113.100	-49.300	0.000	17.666	
NO.66	1320.00	-113.100	-115.100	-50.300	0.660	17.666	
NO.67	1340.00	-115.100	-117.100	-51.300	1.310	17.666	
NO.68	1360.00	-117.100	-119.100	-52.300	1.940	17.666	
NO.69	1380.00	-119.100	-121.100	-53.300	2.550	17.666	
NO.70	1400.00	-121.100	-123.100	-54.300	3.142	17.666	
NO.71	1420.00	-123.100	-125.100	-55.300	3.712	17.666	
NO.72	1440.00	-125.100	-127.100	-56.300	4.244	17.666	
NO.73	1460.00	-127.100	-129.100	-57.300	4.700	17.666	
NO.74	1480.00	-129.100	-131.100	-58.300	5.100	17.666	
NO.75	1500.00	-131.100	-133.100	-59.300	5.450	17.666	
NO.76	1520.00	-133.100	-135.100	-60.300	5.750	17.666	
NO.77	1540.00	-135.100	-137.100	-61.300	6.000	17.666	
NO.78	1560.00	-137.100	-139.100	-62.300	6.200	17.666	
NO.79	1580.00	-139.100	-141.100	-63.300	6.350	17.666	
NO.80	1600.00	-141.100	-143.100	-64.300	6.450	17.666	
NO.81	1620.00	-143.100	-145.100	-65.300	6.500	17.666	
NO.82	1640.00	-145.100	-147.100	-66.300	6.500	17.666	
NO.83	1660.00	-147.100	-149.100	-67.300	6.450	17.666	
NO.84	1680.00	-149.100	-151.100	-68.300	6.350	17.666	
NO.85	1700.00	-151.100	-153.100	-69.300	6.200	17.666	
NO.86	1720.00	-153.100	-155.100	-70.300	6.000	17.666	
EP	1740.00	-155.100	-157.100	-71.300	5.750	17.666	

工事番号	号
路線名	(国) 398号
施工地名	本吉郡南三陸町戸倉字波佐谷内
工事名	平成 年度 工事 (工区)
図面名	検討縦断面図
縮尺	図示 位置
設計者	設計年度
宮城県	図番 (/)

復興道路整備断面イメージ

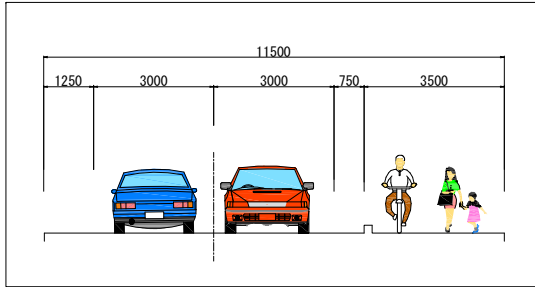

復興道路

標準横断面図 S=1:400

②—②

幅杭設置余裕幅(盛土部)

盛土高 (m)	設置巾 (m)
0 ~ 5	0.50
5 ~ 10	0.50 ~ 1.00
10 ~ 15	1.00 ~ 1.50
15 ~ 20	1.50 ~

幅杭設置余裕幅(切土部)

切土高 (m)	設置巾 (m)	
	地形急峻	地形なだらか
0 ~ 3	1.00	0.70
3 ~ 7	2.00	0.70
7 ~ 14	3.00	1.00
14以上	4.00	1.50

漁港

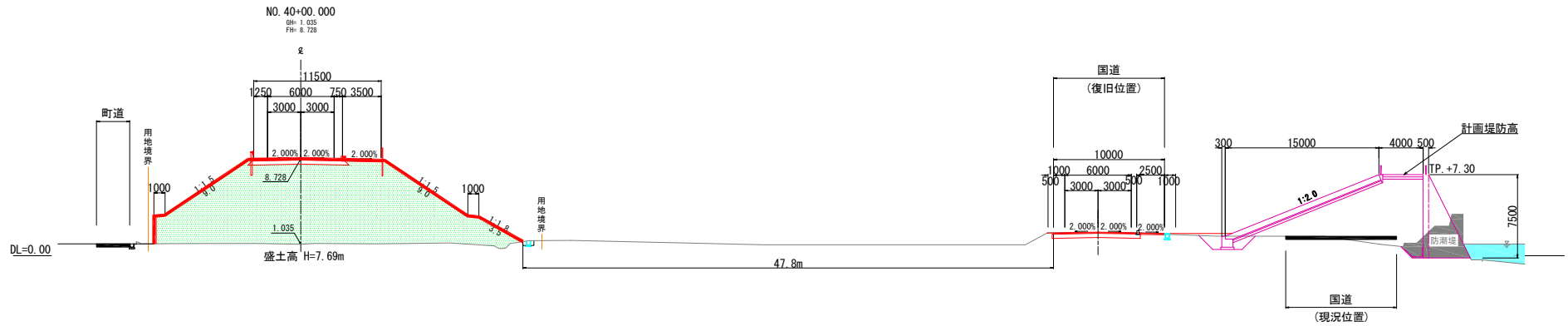

①—①

復興道路

漁港

